

Service Manual

Blender

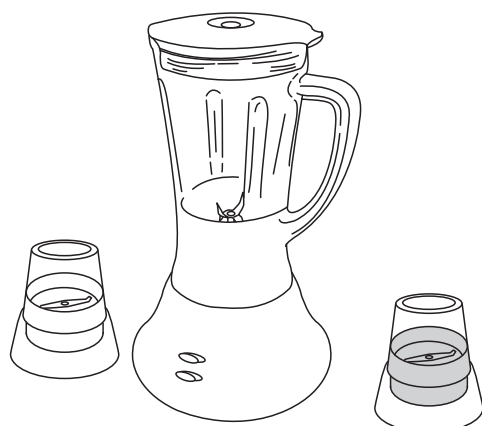

MX-J120P

MX-J120PWTB

Color WHITE

MX-J120PWTB SAUDI ARABIA

Specification

Power supply	Local supply rating	Dimensions(HxWxD)	38.0x20.8x20.0cm
Operation rating	Continuous	Weight	MX-J120P 2.3kg
	(Repetition 3 min. ON. 1 min. OFF)		
Rating Speed	11,100~13,900r.p.m	Accessories	Mill attachment
Blender Container	Maximum 1000ml (Plastic)		

*Specification are subject to change without notice.

WARNING

This service information is designed for experienced repair technicians only and is not designed for use by the general public. It does not contain warnings or cautions to advise non-technical individuals of potential dangers in attempting to service a product. Products powered by electricity should be serviced or repaired only by experienced professional technicians. Any attempt to service or repair the product or products dealt with in this service information by anyone else could result in serious injury or death.

CONTENTS

	Page		Page
1 PARTS LOCATION : Model No. MX-J120PWTB	2	5 DISASSEMBLY INSTRUCTIONS	6
2 REPLACEMENT PARTS LIST : Model No. MX-J120PWTB	3	6 HOW TO USE DRY MILL	10
3 SCHEMATIC DIAGRAM : Model No. MX-J120PWTB	4	7 TROUBLE SHOOTING GUIDE	11
4 GENERAL	5	8 PACKING INSTRUCTIONS	12

Panasonic

© 2005 Matsushita Electric Industrial Co., Ltd. All rights reserved. Unauthorized copying and distribution is a violation of law.

1 PARTS LOCATION:Model No. MX-J120PWTB

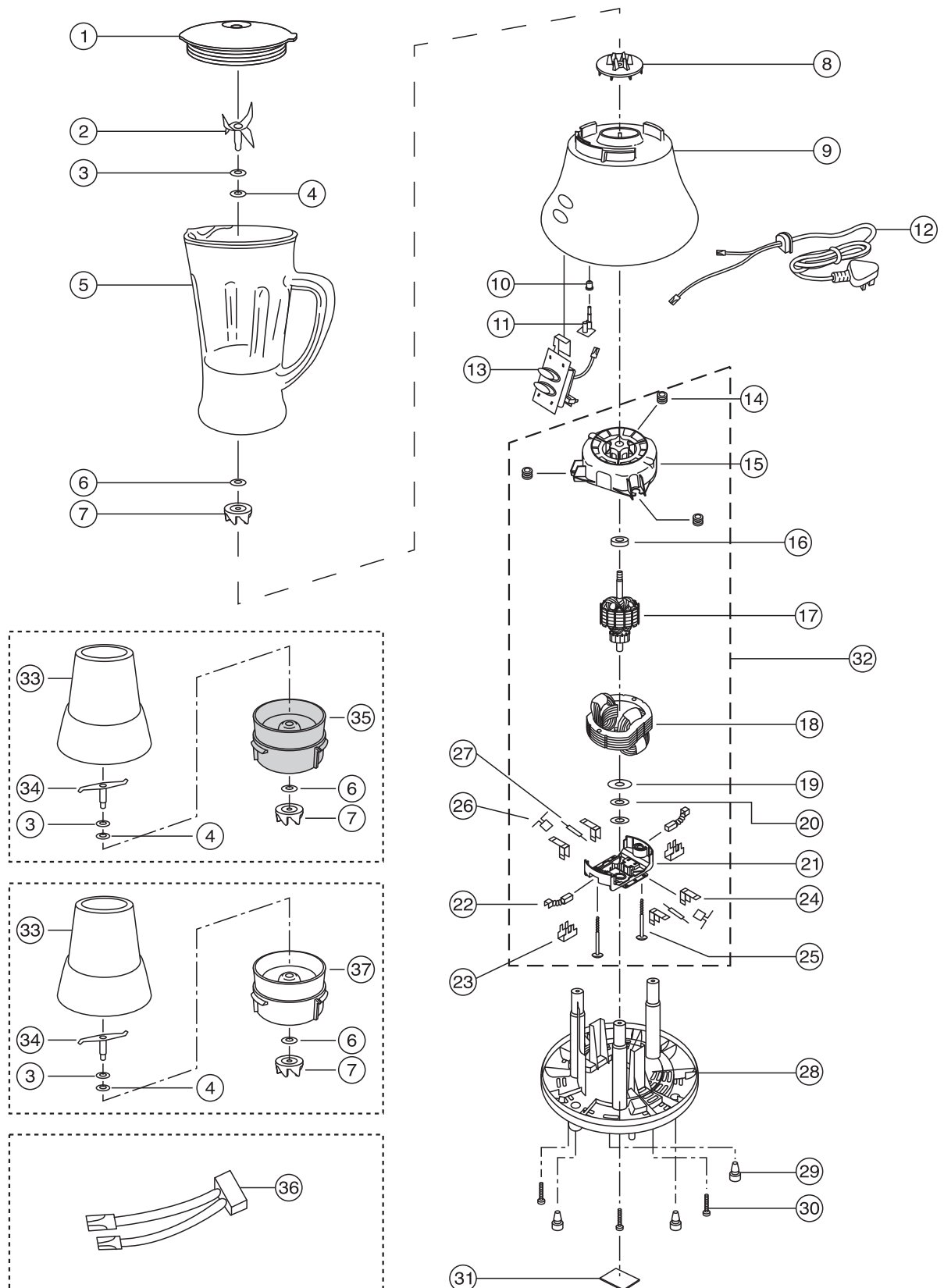

2 REPLACEMENT PARTS LIST: Model No. MX-J120PWTB

Important safety notice

Components identified by  mark have special characteristics for safety

When replacing any of these components, use only manufacturer's specified parts.

Ref. No.	Part No.	Part Name & Description	Remarks
1	X0201-120	Cover A	
2	X0224-050	Juice Cutter Ass'y	
3	X0217-010	Waver Washer	
4	X0227-030	Main Shaft Washer	
5	X0190-010	Juice Cup U	
6	X0227-060	Shaft Washer	
7	X0411-100R	Connector (Upper)	
8	VB99-184-\$	Connector (Lower)	
9	X0101-140	Body U	
10	X0104-010	Seal Cap	
11	X0505-020	Safety Device Pin	
12	X0550-720	Cord U	 SAUDI ARABIA
13	X0501-290	Switch Ass'y	
14	X0103-020	Body Cover Gum	
15	93-029535C	Motor Cover	
16	35-069117	Ring Washer	
17	92-029889C	Armature Ass'y	
18	91-0292145C	Field Ass'y	
19	35-069102	Fiber Washer	
20	35-069069	Baku Washer	
21	93-019531C	Frame A	
22	53-029086	Brush Ass'y	
23	21-029011	Carbon Box	
24	21-019034	Lead Wire Terminal	
25	38-109103R	Motor Setting Screw	
26	50-169017	P.F. Condensor	
27	30-039103	Choke Coil	
28	X0130-130	Bottom Plate	
29	X0133-020	Leg	
30	XTN4+20BFJ	Screw	
31	X0173-221	Name Plate	SAUDI ARABIA
32	X0701-421	Motor Ass'y	
33	X0203-230	Mill Cup	
34	X0224-120T	Mill Cutter Ass'y	
35	X0195-100	Mill Cup Base Ass'y	
36	X0506-150	Condensor U	
	X0909-820	Operation Book	SAUDI ARABIA
	X0911-240	Protection A	
	X0912-240	Protection A	
	X0915-130	Paper Plate (A)	
	X0915-110	Paper Plate (B)	
	X0903-740	Carton Box	SAUDI ARABIA
	XZB10x50A030	Bag	
	XZB20x30A030	Polyethylene Bag	
37	X0195-100D	Mill Cup Base Ass'y (White)	

3 SCHEMATIC DIAGRAM: Model No. MX-J120PWTB

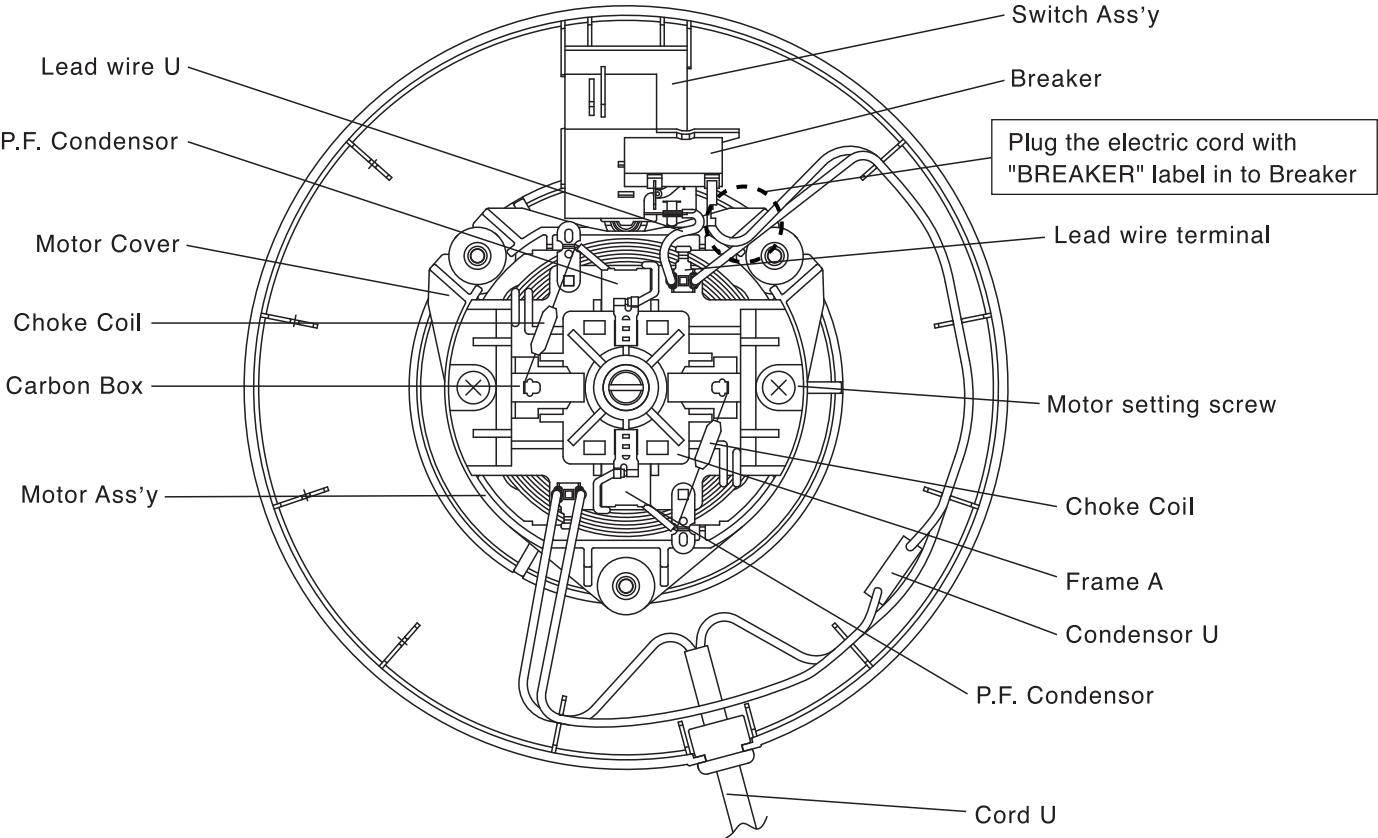

4 GENERAL

BREAKER

A breaker is provided at the switch, for protection of the motor against rare short-circuiting. Therefore, when the motor is overloaded (i.e. when the breaker is subjected to the current larger than specified), the breaker will operate to open the circuit, causing the motor to stop. The breaker can be reset by depressing the "O" button of switch. When the motor is stopped, take the following actions.

1. Switch to "O" Button. Disconnect the power plug. Then, the "O" Button switch will reset the breaker.

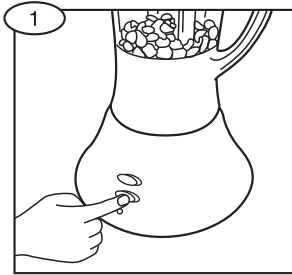

BREAKER PERFORMANCE

Take the reading of current at which the breaker operates under the constant-current power source (D.C) at 20°C.

Breaker for 240V Rating

- . not to operate within 1 minute under
- . to operate within 1 minute under

2. Reduce the ingredients to less than a half in volume.

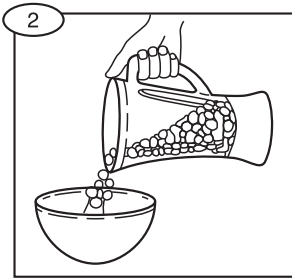

3. Resume operation.

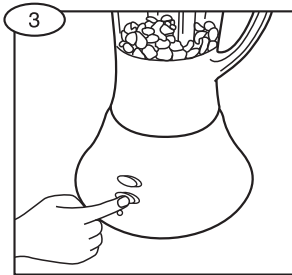

CAUTIONS

- Maximum ingredient volume: 1,000 ml.
- Do not crush ice cubes only.
- Do not operate blender longer than 3 min. at one time. Rest for 1 min., then resume.
- Dice solid foods first. Blend with water.
- Before using, make sure voltage and frequency indicated on the bottom plate are the same as your local supply.
- When blending meat, fish, garlic or beans, do not fill the blender container over 1/3 full or operate more than 2 min.
- Do not immerse motor housing in water.
- Never remove or attach container when motor is operating.

5 DISASSEMBLY INSTRUCTIONS

5.1. Juice cup and Cutter Ass'y --Fig.1,2

1. Remove the cover A.
2. Turn the connector upper clockwise with long nose pliers.
Then the Cutter Ass'y and connector upper can be removed.

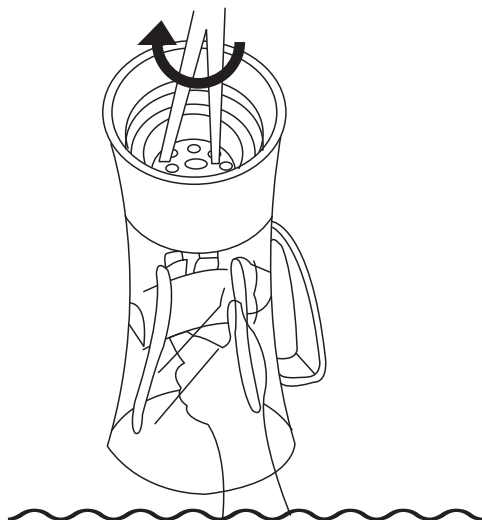

Fig. 1

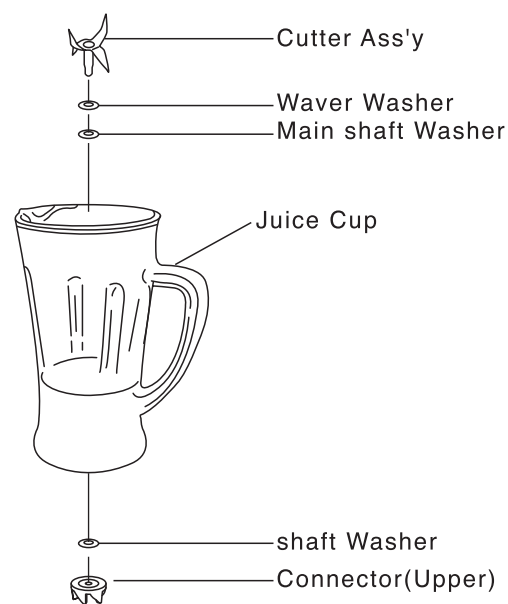

Fig. 2

5.2. Connector(Lower) -Fig.3

1. The bottom plate can be removed when its three screws are loosened.
 2. Hold the part under the motor shaft by means of a screws-driver, then turn the connector (lower) clockwise. The connector (lower) can be removed.
- . The connector (lower) can be relatively easily removed by means of hitting its projecting section clockwise with use of a screwdriver grip in a forceful manner.

5.3. Botton plate, Body U and Cord U - Fig. 4

1. The Body U can be removed downwards from its cover when the Cord U and the breaker switch both held by the Body U are taken out.

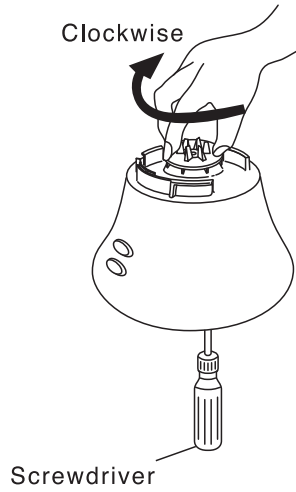

Fig. 3

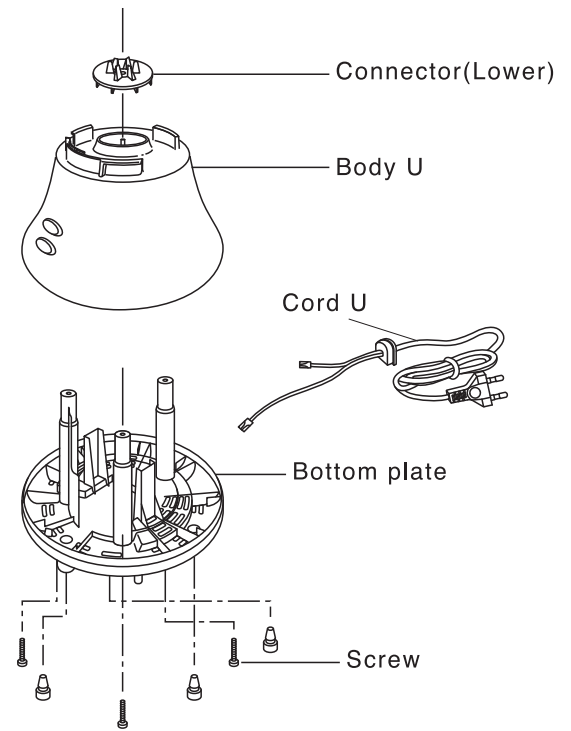

Fig. 4

5.4. Motor Cover ,Frame A ,Armature Ass'y and Field Ass'y -Fig.5

1. Remove the bottom plate and Body U. (Fig.3)
2. The motor cover, the Frame A ,the Armature Ass'y and Field Ass'y can be disassembled when the motor setting screws and the wiring between the lead wire terminal of the frame and the Brush Ass'y guide are all removed.

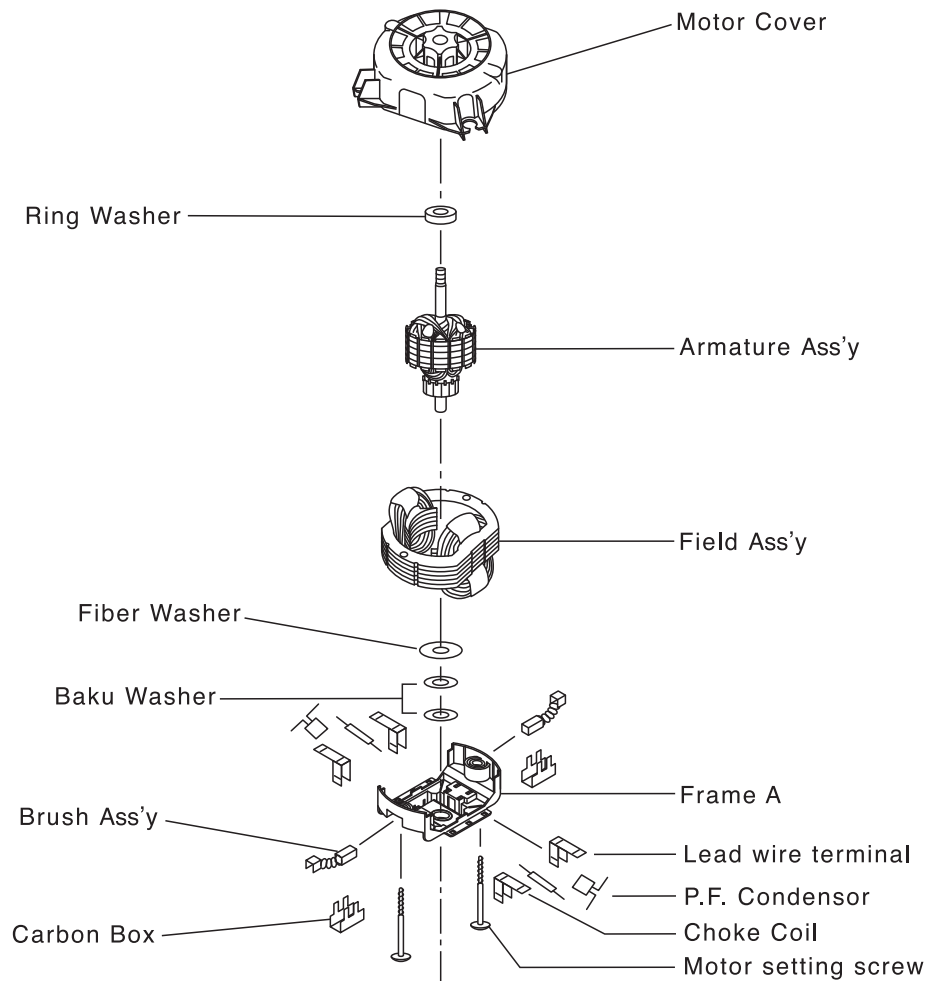

Fig. 5

5.5. Brush Ass'y

1. Remove the bottom plate.
 2. The Brush Ass'y are fixed on Carbon Box. Pull out the Brush Ass'y by retracting claws of the Brush Ass'y terminals , protruding from the sides of the Carbon Box.
- . Be sure to replace the two Brush Ass'y at the same time.

5.6. Reassembly of Motor Cover,Frame A,Armature Ass'y and Field Ass'y -Fig.6, 7

1. Put the motor cover upside-down and set on it the Ring Washer the Armature Ass'y, the Baku Washer and the Field Ass'y frame in this order.(Note that lead wire terminal should be fixed beforehand.) then, fix them to the motor cover by means of motor setting screws. In this case adjust clearance in the thrust diretion and rotability of the Armature Ass'y by adding or reducing the number of Ring washers.
2. Set the Brush Ass'y and the Carbon Box in the frame. (Fig.7)
3. Solder the four lead coils of the Field Ass'y to the lead wire terminal,for wiring. (Fig.7)
4. Solder the lead of Choke Coil to the Carbon Box and lead wire terminal, for wiring (Fig.8)
5. Solder the lead of P.F. Condensor to the lead wire terminal and Insert the flag terminal of P.F. Condensor into Metal Holder of Frame A,for wiring (Fig.8)

Note:

When the motor is found out of order, requiring replacement, be sure to renew the Armature Ass'y, the Field Ass'y and the Brush Ass'y at the same time . Furthermore, when the motor cover and/or the frame A are found defective on that occasion, replace them with new ones, as well, without fail.

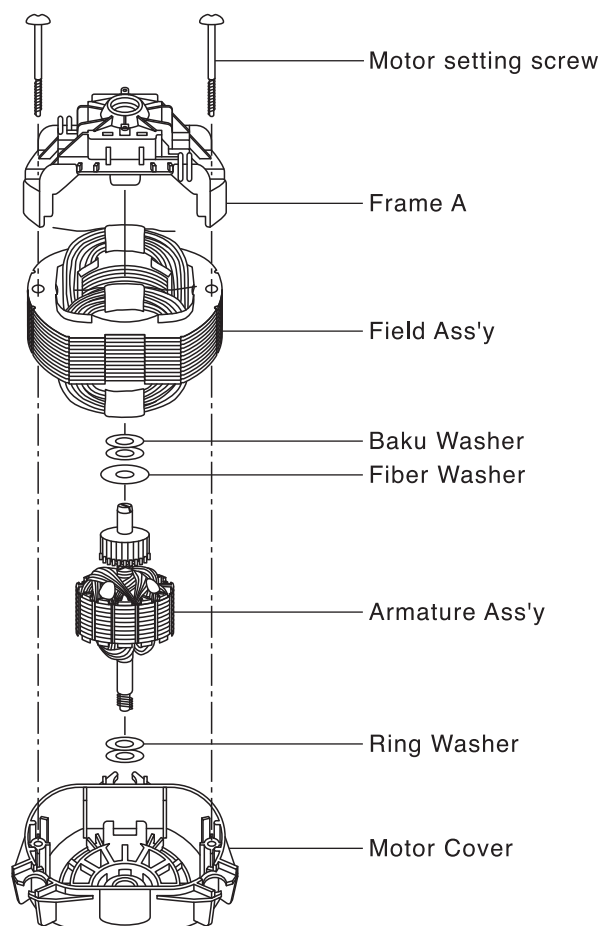

Fig. 6

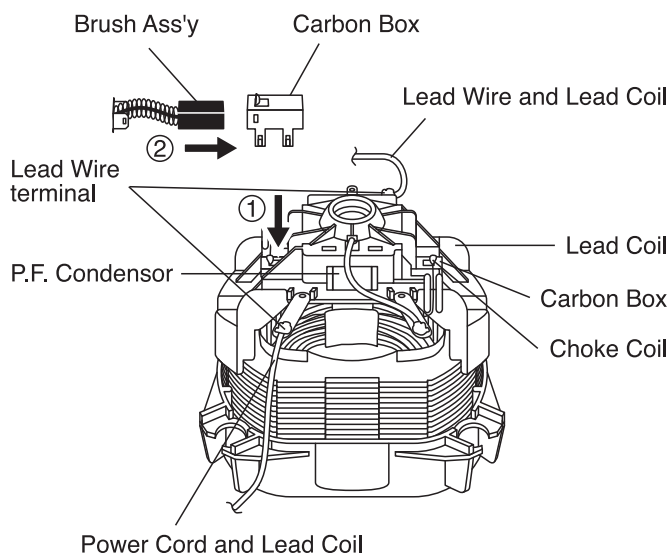

Fig. 7

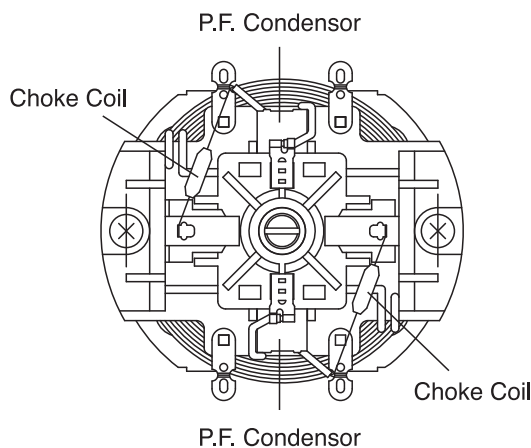
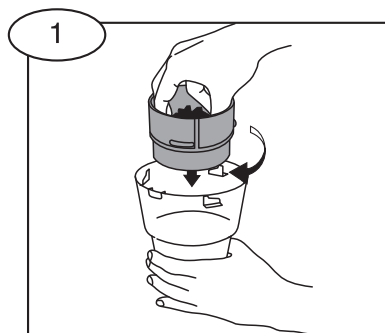
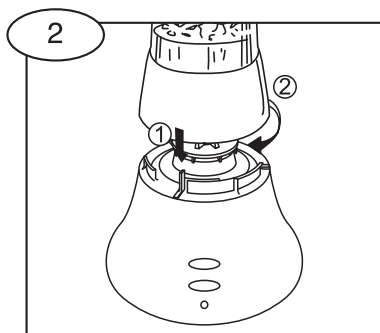

Fig. 8

6 How To Use Dry Mill



Turn mill upside down, and place ingredients in. Twist blade base onto mill container and lock.



Place container and blade base on motor housing. Twist container clockwise to lock.

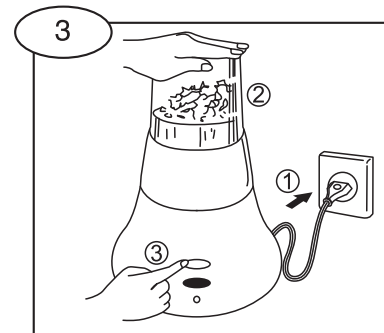

Plug in. Support container than select one of the speed buttons as required. Use PULSE button for precision blending.

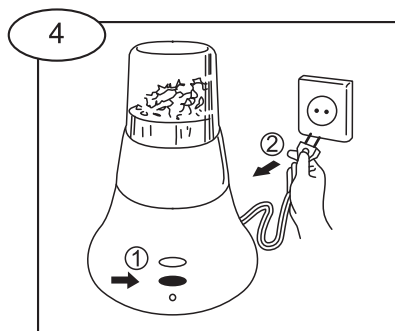

Switch off. Unplug.
Support container until operation finishes completely.

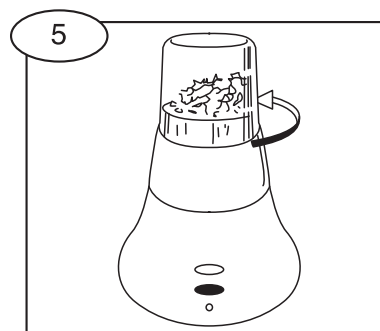

Twist container counterclockwise to remove.
Be sure to grip plug when unplugging.
Never pull on the cord.



Turn container upside down and tap with hand to release ingredients stuck in blades. Twist blade base counterclockwise to remove. Remove ingredients.

CAUTION :

- Do not place any ingredients more than maximum amount of 50 g .
- Do not operate With empty container.
- Do not operate more than 90 seconds at one time.

7 TROUBLE SHOOTING GUIDE

Symptom	Possible Cause	Countermeasure
·Motor fails to Armature Ass'y Or humming noise is heard	1.Motor(Armature Ass'y,Field Ass'y) defective. 2.Wiring connection improper 3.Switch defective 4.Cord U broken 5.The current breaking function of switch is on 6.Motor short-circuited 7.Wear of Brush Ass'y	1.Replace Motor(Armature Ass'y,Field Ass'y) 2.Correct it 3.Replace Switch 4.Replace Cord U 5.Push "O" Button and then "1" Button of Switch 6.Replace Motor(Armature Ass'y, Field Ass'y) 7.Replace the two Brush Ass'y at the same time
·Cutter Ass'y fails to rotate	1.Cutter Ass'y shaft seizes up 2.Wear of Connector	1.Replace Cutter Ass'y and Cup Base Ass'y 2.Replace Connector(Upper or lower)
·Noises and vibrations are observed	1.Fastened conditions of screws improper 2.Cutter Ass'y deformed 3.Motor Shaft eccentric 4.Assembly of Juice Cup improper or fastened conditions of Cup Base Ass'y to Juice cup improper.	1.Fasten tightly 2.Replace Cutter Ass'y 3.Replace Armature Ass'y 4.Reassemble properly
·Juice or other material leaks	1.Juice cup cracked 2.Packing improperly fixed 3.Packing damaged 4.Juice cup and Cup Base Ass'y insufficiently fastened	1.Replace Juice cup 2.Properly fix Packing 3.Replace Packing 4.Fasten them firmly
·Current Breaking Function of Switch Ass'y fails and cause motor burning	Breaker of Switch Ass'y short-circuited	Replace both Motor(Armature Ass'y and Field Ass'y) and Switch Ass'y

8 PACKING INSTRUCTIONS

